

355-399 E Maple Street
Aberdeen, NC 28315

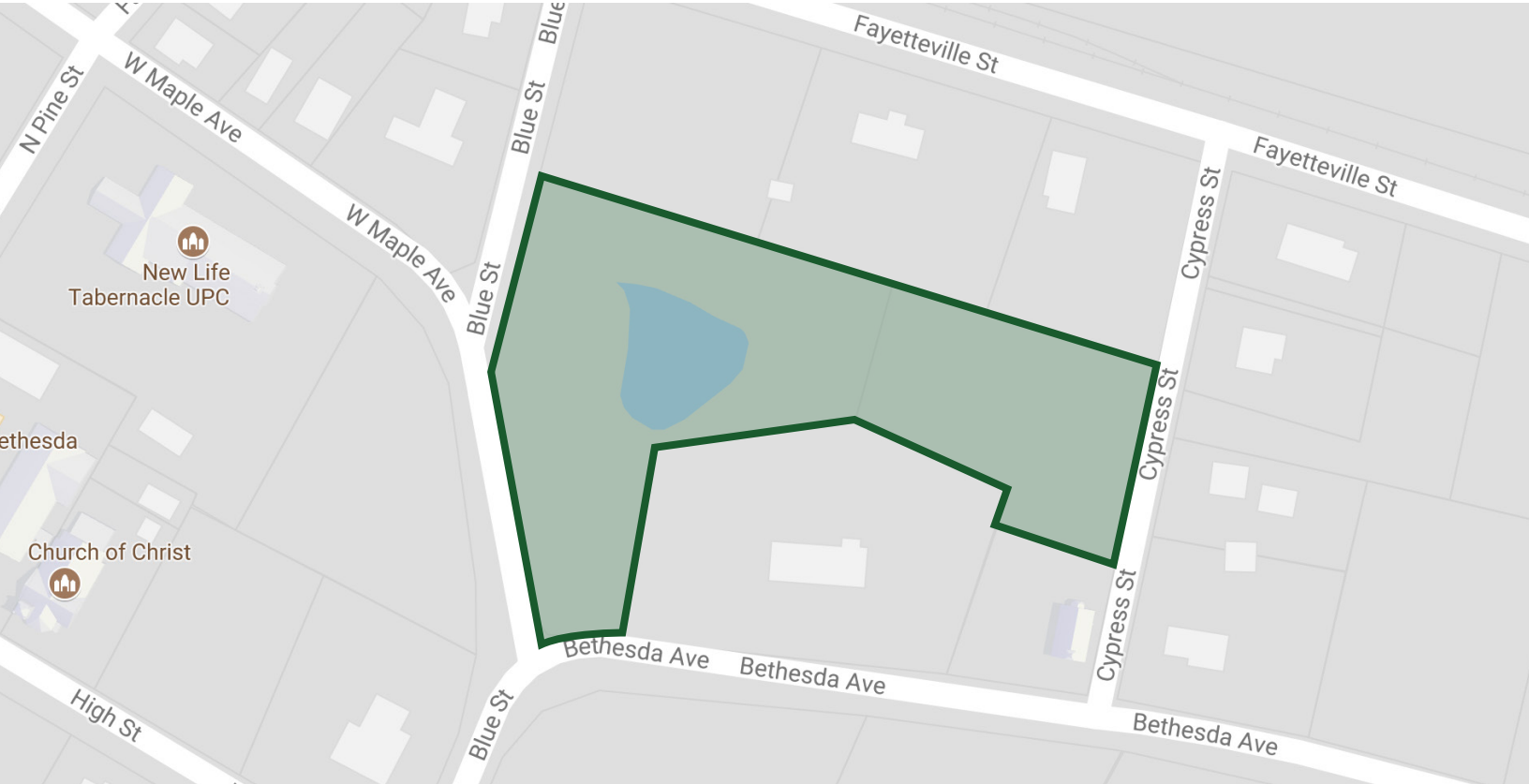

For Sale | Land/Acreage | \$100,000



Building Attributes

Acreage	3
Zoning	R-20-16
Parcel ID	98000747 & 00056439
DB	2002 /Page 195

Features

- US Hwy 1 to Left onto W. Maple Avenue Follow to Blue Street.
- Property is located on the left fronting Bethesda Ave, W. Maple Ave Blue Street and Cypress Street.
- Corner Lot

Janice M. Dixon, CCIM

Principal

C 910-916-5771

jdixon@ccim.net

www.synergycommercialproperties.com

Synergy Commercial Properties, LLC

Brokerage, Management & Consulting

281 W. Pennsylvania Avenue

Southern Pines, NC 28387

T 910-295-1801 | F 877-255-7990

Aerial Map

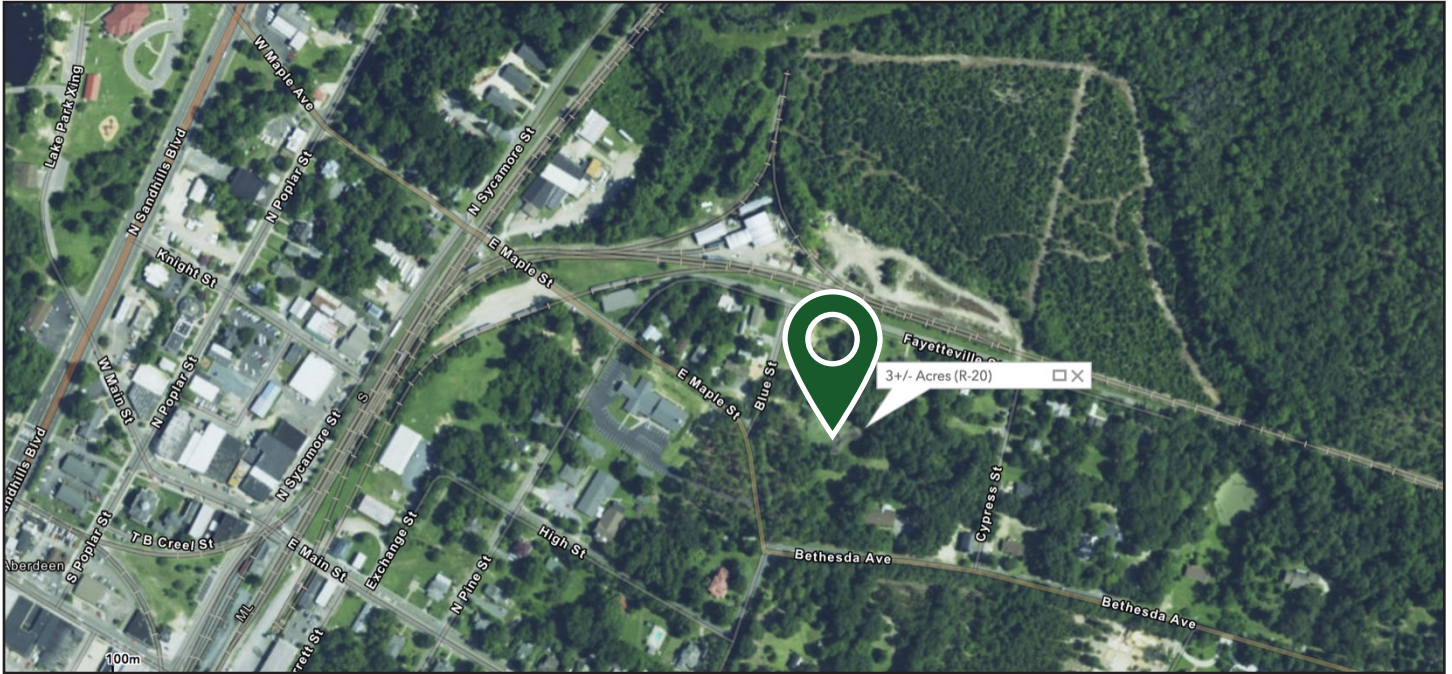

Vicinity Map

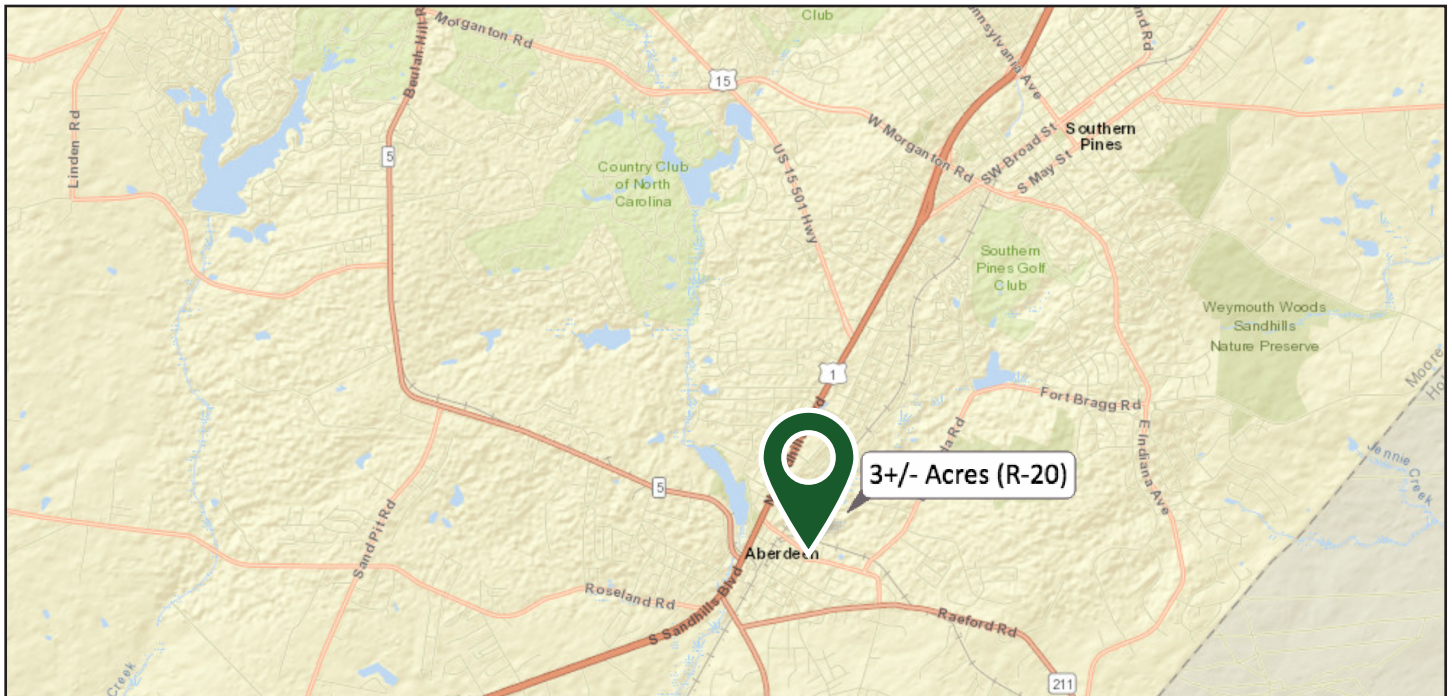

Janice M. Dixon, CCIM
Principal
C 910-916-5771
jdixon@ccim.net
www.synergycommercialproperties.com

Synergy Commercial Properties, LLC
Brokerage, Management & Consulting
281 W. Pennsylvania Avenue
Southern Pines, NC 28387
T 910-295-1801 | F 877-255-7990

Locator Map

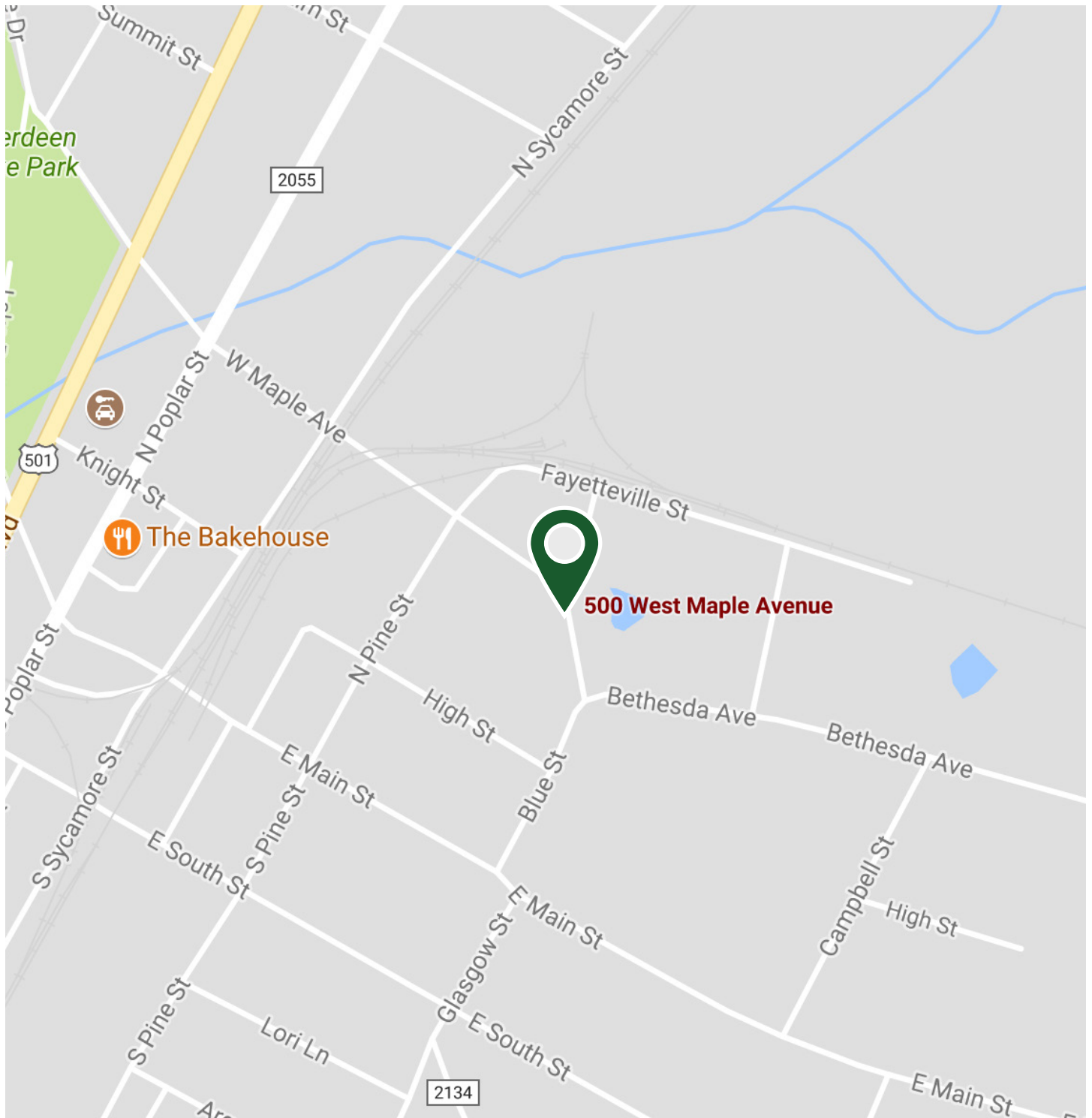

Janice M. Dixon, CCIM

Principal

C 910-916-5771

jdixon@ccim.net

www.synergycommercialproperties.com

Synergy Commercial Properties, LLC

Brokerage, Management & Consulting

281 W. Pennsylvania Avenue

Southern Pines, NC 28387

T 910-295-1801 | F 877-255-7990

Demographics

Population	1 Mile	3 Miles	5 Miles
2017	5,259	23,274	45,849
Total Households	1 Mile	3 Miles	5 Miles
2017	2,282	10,558	20,532
Average Household Income	1 Mile	3 Miles	5 Miles
2017	\$61,312	\$63,934	\$75,006

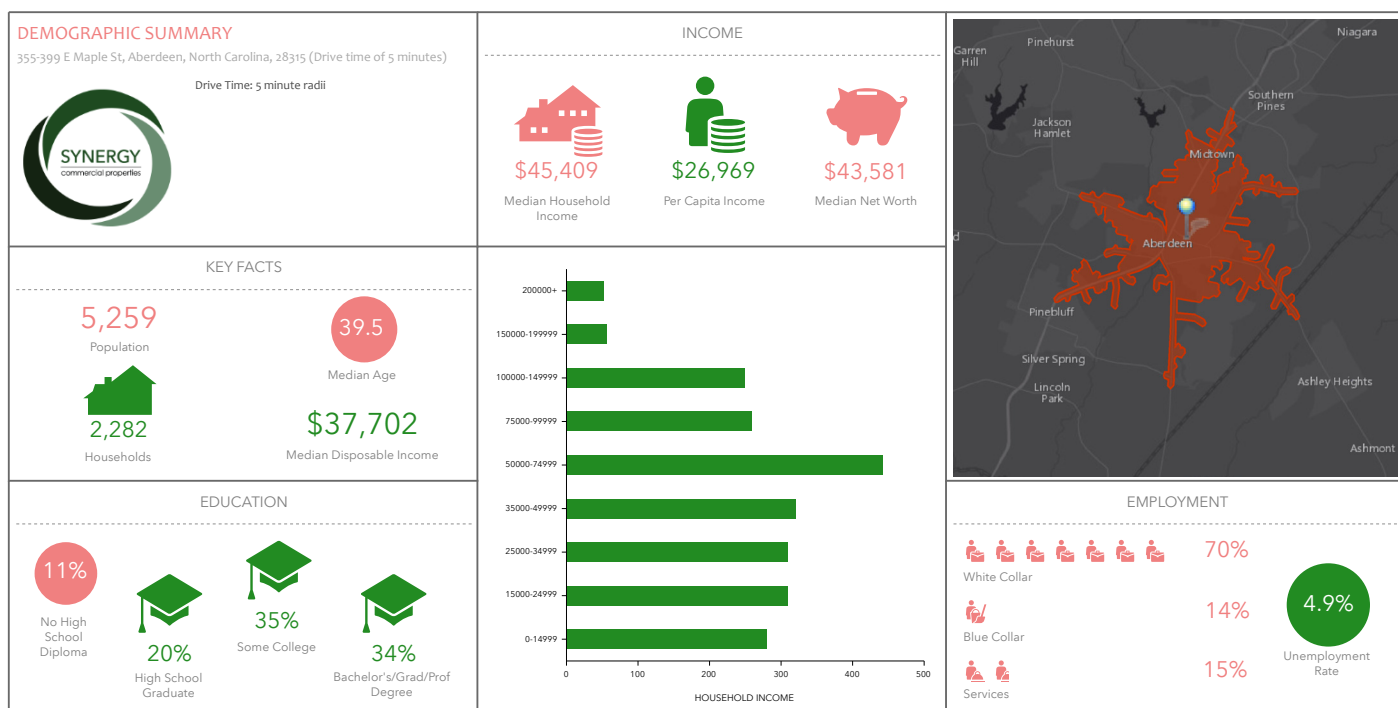

The information contained herein was given to Synergy Commercial Properties by the owner of the property or other sources we deem reliable. We have no reason to doubt its accuracy, but we do not guarantee it. All information should be verified prior to purchase or lease.

Janice M. Dixon, CCIM

Principal

C 910-916-5771

jdixon@ccim.net

www.synergycommercialproperties.com

Synergy Commercial Properties, LLC

Brokerage, Management & Consulting

281 W. Pennsylvania Avenue

Southern Pines, NC 28387

T 910-295-1801 | F 877-255-7990